

Extension function

SW is the optional extension terminal, the power of the internal relay trigger is DC30V/1A. Under normal condition, hold the extension switch "S1" for 1s, till the unit sound "DI", the terminal is connecting through. Meanwhile, if you release the button, the terminal will be cut off after 3s, but if you keep the button, the terminal will be connected all the time until you release the button.

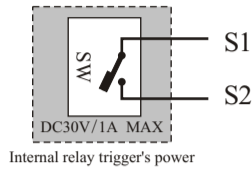

Terminal polarity requirement

	Power	Door 1	Door 2	Extension Unit input/output	CCTV input/output	Extension ring output	2nd door calling	Multi-function terminal
Polarity	✓	✓	✓	✓	✓			
Non-polarity						✓	✓	✓

Connection length and wire requirement



Connection for outdoor camera & CCTV camera

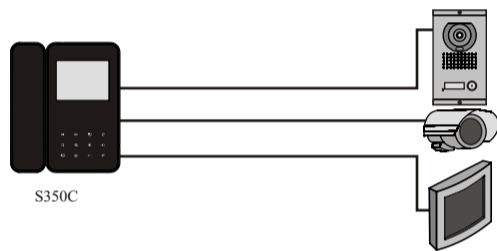

Wiring length	30M	50M	100M
Wiring material requirement between main indoor monitor and outdoor camera	RVV4*0.3mm²	RVV4*0.5mm²	RVV4*0.75mm²
Wiring material requirement between main monitor and sub monitor		SYV75-3	SYV75-5
CCTV input wiring material requirement		SYV75-3	SYV75-5

The resistance rate for the wire should be $\leq 0.06\Omega/m$

To make sure the best image quality and normal operation, please choose the wire with the above indication.

Connection between main monitor and sub monitors

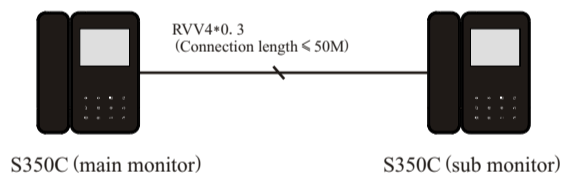

1pc Main monitor +1 pc Sub monitor

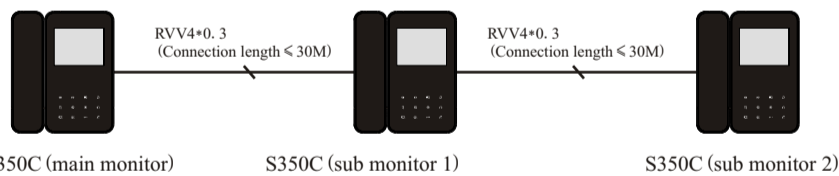

1pc Main monitor +2 pcs Sub monitors

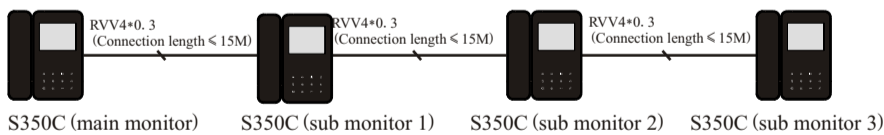

1pc Main monitor +3 pcs Sub monitors

The resistance rate for the wire should be $\leq 0.06\Omega/m$

To make sure the best image quality and normal operation, please choose the wire with the above indication.

The distance between outdoor camera and the last sub monitor should be $\leq 100m$

Connection between sub monitors: series connection

Connection diagram between Indoor monitor and outdoor camera (1pc Indoor monitor + 2pcs outdoor camera + 3pcs CCTV cameras + 4pcs monitor)

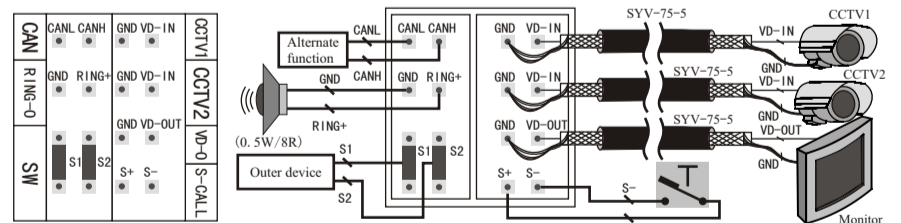
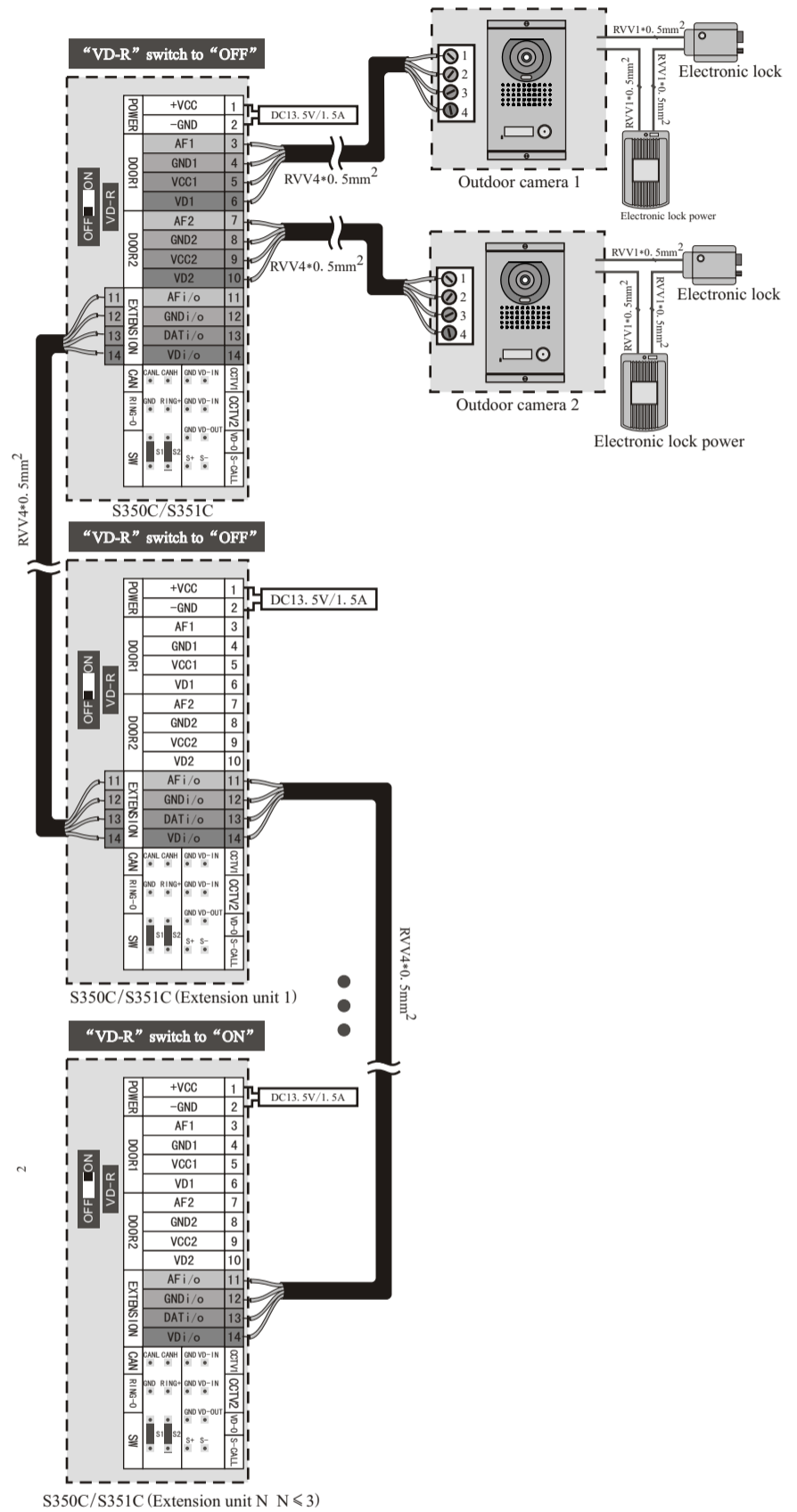

S-CALLL operation principle: connect a normal open switch on S1 and S2 terminal.

When press the switch, the unit will sound the ring, to remind that somebody is calling, but no picture display.

This function is suitable for 2nd door. (optional function)

Specifications and accessories

Specifications

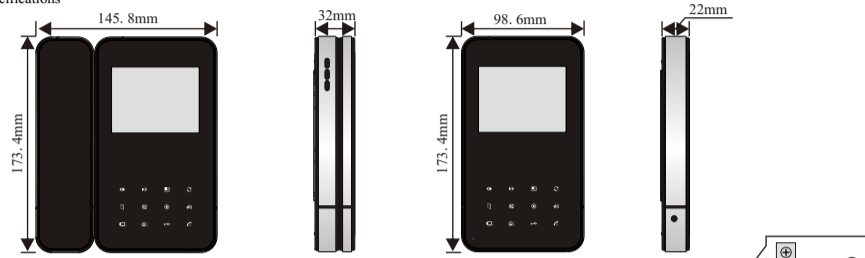

Accessories

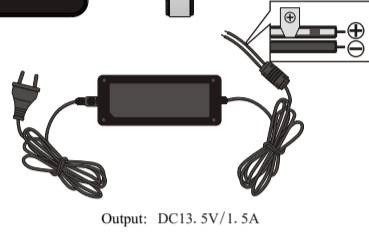
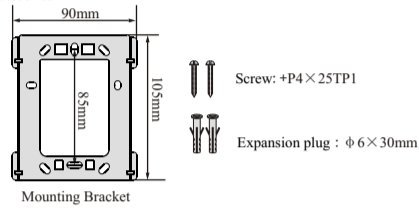

Installation Instruction

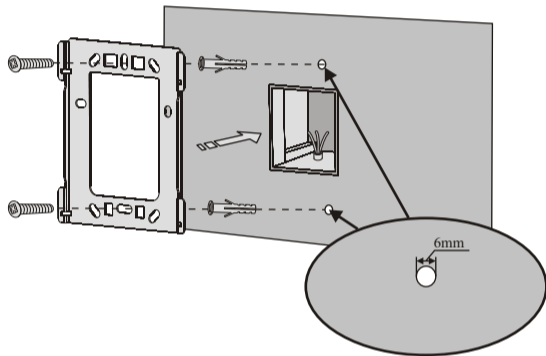

1. Concealed wiring: fix the bracket on the connection box which already installed on the wall.
Open wiring: drill 2 holes which distance should be 8.4cm, insert 2 expansion plug, then fix the bracket with screws.

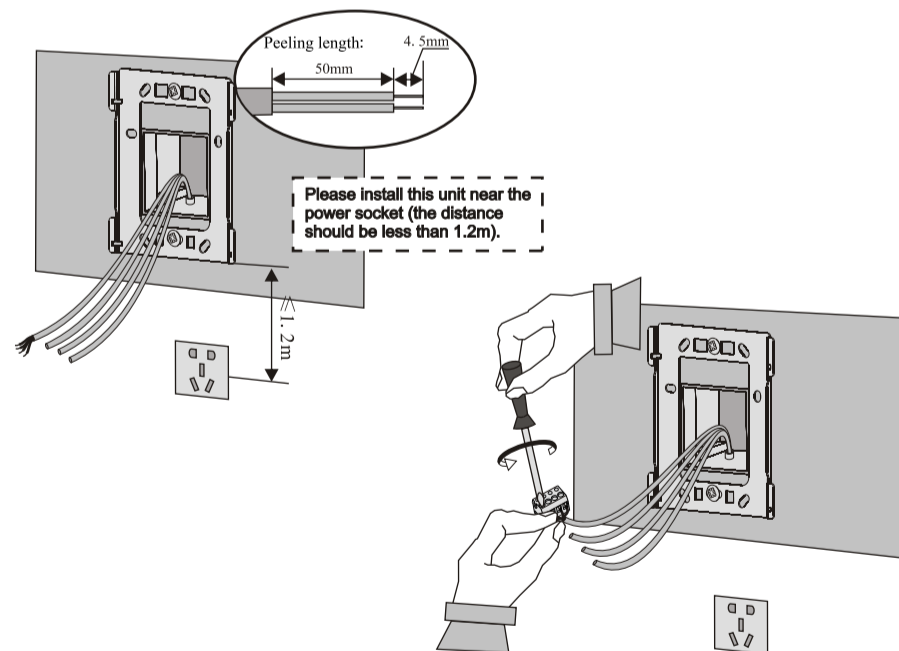
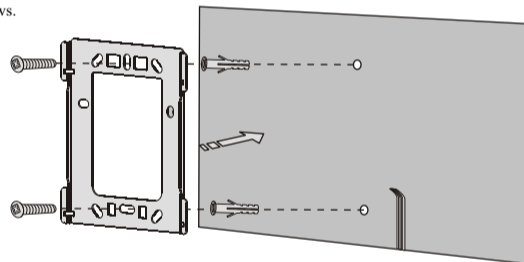

2. As the picture showing, peel the wire, then insert to the connection terminal, fix them with screw driver. Then check if they are firm enough.

Installation Instruction

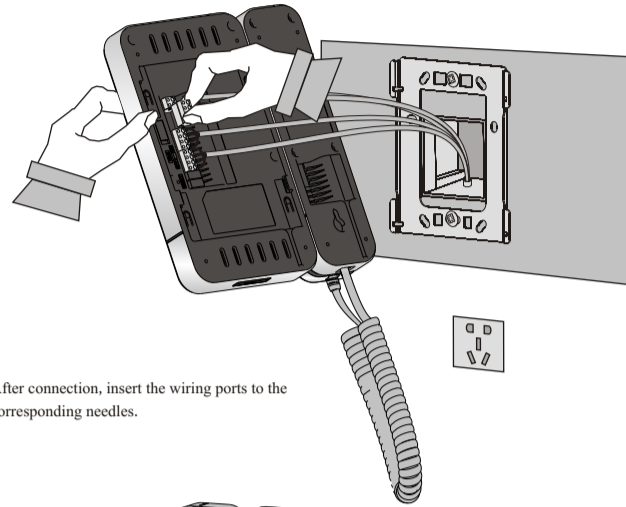

3. After connection, insert the wiring ports to the corresponding needles.

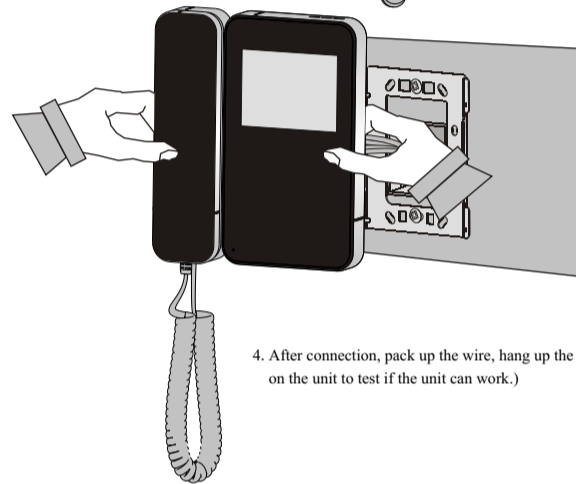

4. After connection, pack up the wire, hang up the unit to the bracket.(after hang up, power on the unit to test if the unit can work.)

Installation attention

1. When you choose the place to install the unit, please pay attention to:

- Keep sufficient space for ventilation and easy communication.
- Keep sufficient space to adjust while installing.
- Not put hot resource under the unit.
- The socket outlet shall be installed near the equipment and shall be easily accessible.

2. Do not expose the unit to sunshine or rain:

- Even if you do not use it, don't expose it to sunshine or rain.

3. Do not expose to intense light:

- Spotlight may cause stain or striation in the screen.

4. Do not disassemble the unit by yourself:

- Improper disassembly may damage the unit or cause electric shock.

5. Do not splash water on the unit:

- Install the unit in dry place. In case that the unit gets wet, turn off the unit and contact your dealer.

6. Check the ambient temperature and humidity:

- Avoid using the unit where the temperature is hotter or colder than specified, otherwise the internal parts may get affected. Special care is required to use the unit at high temperature and humidity.

7. In case of trouble:

- If any trouble occurs while you are using the unit, turn off the power and contact your dealer to avoid worse problem or unpredictable accident.

8. About operation:

- Keep the unit away from magnetic equipments such as microwave oven or big speaker. If the unit will not be used for a long time, please switch it off.

9. About clean:

- Use soft cloth to clean the unit. Do not use any impregnant, such as alcohol, benzene. If you have any problem, please contact your dealer.